

NOTE:

1 A POSITIVE GOING VOLTAGE AT TERMINAL 2, RELATIVE TO TERMINAL 1, CAUSES A DECREASE IN PRESSURE AT THE SOUND OUTLET.

2 LOCATED FROM TWO SURFACES FOR CUSTOMER CONVENIENCE. ONLY APPLICABLE FROM ONE SURFACE, NOT TO BE USED TOGETHER. HORIZONTAL LOCATION FOR TERMINAL CENTERED TO ±0,17 [.007].

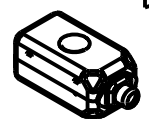
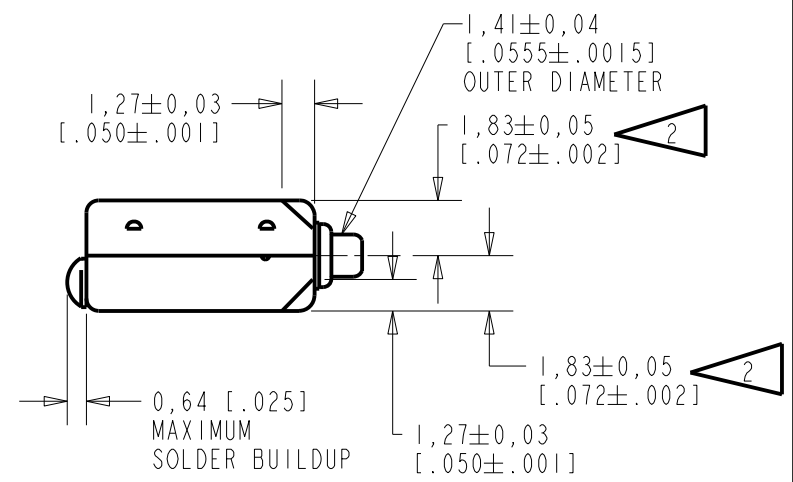
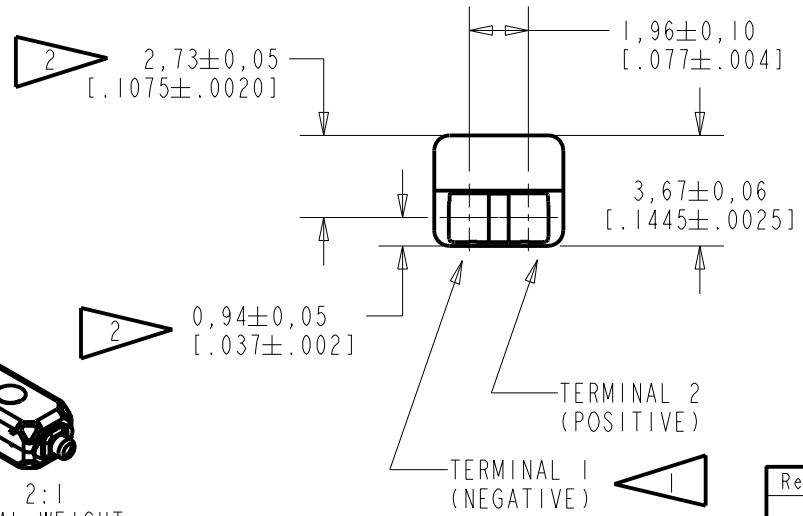

SCALE 2:1  
NOMINAL WEIGHT  
.42 GRAMS

DIMENSIONS IN MILLIMETERS [INCHES]

| Revision | C.O. #    | Implementation Date | RELEASE LEVEL | REVISION |
|----------|-----------|---------------------|---------------|----------|
| B        | CI0115009 | 8-3-13              | Active        | B        |
| A        | CI0103592 | 1-26-06             |               |          |

**KNOWLES ELECTRONICS**  
ITASCA, ILLINOIS U.S.A.

|                      |               |              |               |
|----------------------|---------------|--------------|---------------|
| SCALE: 4:1           |               | DR. BY: AB   | DATE: 1-19-06 |
| DO NOT SCALE DRAWING |               |              |               |
| TITLE: RECEIVER      | FEC-26368-102 | GJP          | 1-26-06       |
| OUTLINE DRAWING      | SHT 1.1       | APP. BY: GJP | DATE: 1-26-06 |

THE FEC-26368-102 IS A FERROFLUID DAMPED EC. THE AMPLITUDE OF THE PEAK OF THE FREQUENCY RESPONSE IS +2dB RELATIVE TO THE SENSITIVITY AT 1000Hz UNDER CONSTANT VOLTAGE DRIVE CONDITIONS.

FERROFLUID DAMPING

FEC-26368-102

SHEET 2.1

CONSTANT VOLTAGE DRIVE CONDITIONS

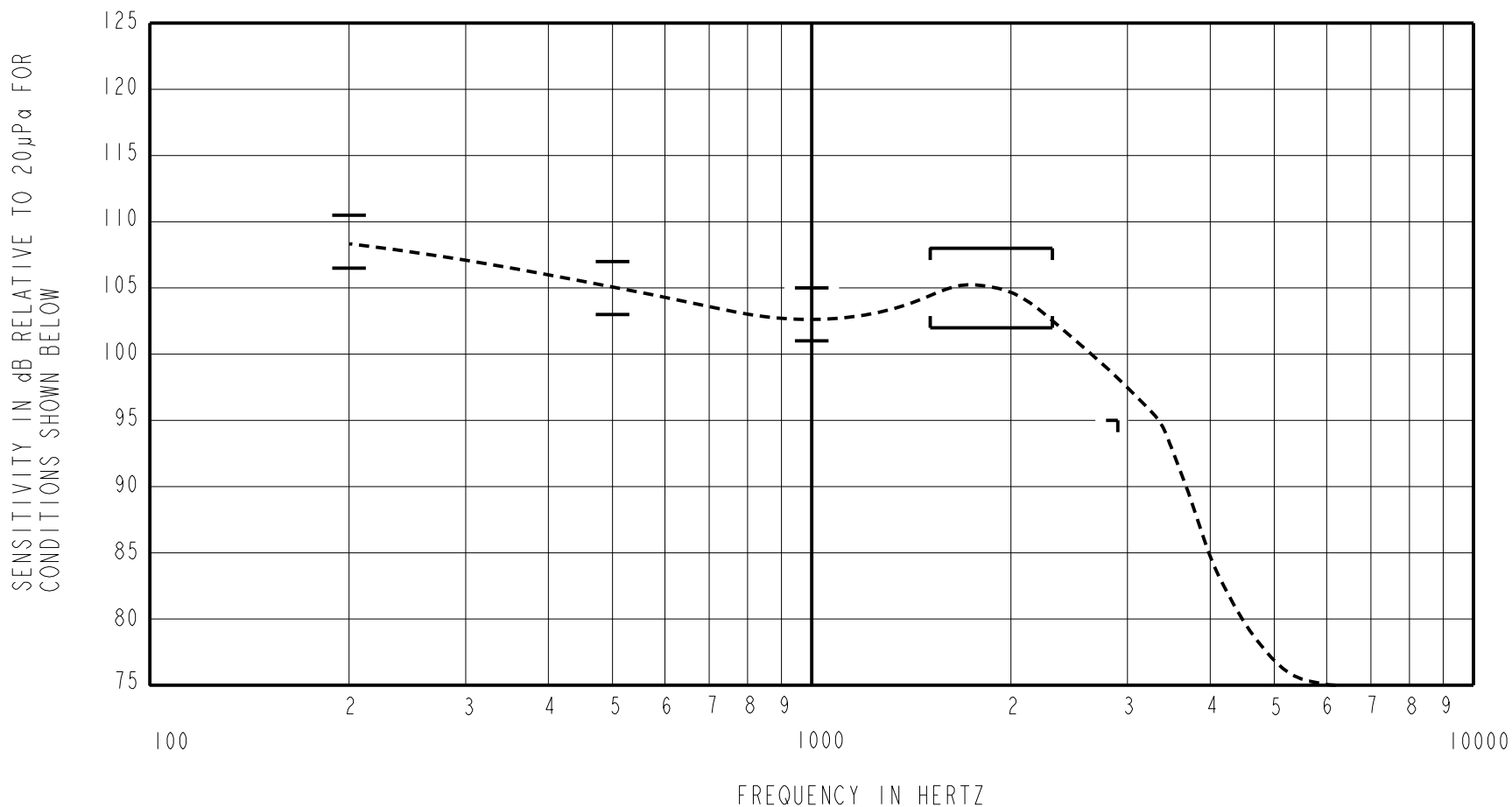

ACOUSTICAL

SENSITIVITY

DEVICE WILL PRODUCE THE SPL LISTED BELOW UNDER TEST CONDITIONS DESCRIBED IN TABLE 3. NOMINAL SENSITIVITY AT 1000 Hz IS dB RELATIVE TO 20µPa. ALL OTHER VALUES IN dB RELATIVE TO THE SENSITIVITY AT 1000 Hz.

| FREQUENCY (Hz) | MINIMUM | NOMINAL | MAXIMUM |
|----------------|---------|---------|---------|
| 200            | +3.5    | +5.5    | +7.5    |
| 500            | +0.0    | +2.0    | +4.0    |
| 1000           | -2.0    | 103.0   | +2.0    |
| 1510-2310      | -1.0    | +2.0    | +5.0    |
| 2900           | -8.0    | ---     | ---     |

TABLE 1

TOTAL HARMONIC DISTORTION

DEVICE WILL NOT EXCEED TOTAL HARMONIC DISTORTION LEVELS LISTED BELOW.

| FREQUENCY (Hz) | AC DRIVE (V rms) | DC BIAS (mA) | LIMIT (%) |
|----------------|------------------|--------------|-----------|
| 640            | 0.127            | 0            | 6         |
| 960            | 0.127            | 0            | 6         |
| 960            | 0.254            | 0            | 10        |

TABLE 2

TEST CONDITIONS

|                        |   |
|------------------------|---|
| NOMINAL SOURCE VOLTAGE | 0.127 V rms, 0mA DC BIAS  |
| SOURCE IMPEDANCE       | <1 Ohm  |
| TUBING                 | 10mm [.394"] LONG, 1mm [.039"] I.D.                             |
| COUPLER CAVITY         | 2 CM <sup>3</sup> , SIMULATED ANSI S3.7 TYPE HA-3 (IEC 60318-5) |

TABLE 3

ELECTRICAL

|                    |                 |
|--------------------|-----------------|
| DC RESISTANCE      | 26.3 OHMS ± 10% |
| IMPEDANCE @ 500 Hz | 56 OHMS ± 15%   |
| IMPEDANCE @ 1 kHz  | 100 OHMS ± 15%  |

TABLE 4

ISOLATION: CASE WILL BE ELECTRICALLY ISOLATED FROM THE COIL CIRCUIT.

TEMPERATURE: OPERATING RANGE FROM 0°C TO 63°C (SENSITIVITY WILL NOT VARY BY MORE THAN ±3 dB WITHIN RANGE) SENSITIVITY AT 0°C IS 2dB LOWER THAN THE SENSITIVITY AT ROOM TEMPERATURE.

DELTA PEAK IS 1.5dB HIGHER AT BODY TEMPERATURE (37°C)

STORAGE RANGE FROM -40°C TO 63°C.

| Revision | C.O. #    | Implementation Date | RELEASE LEVEL | REVISION |
|----------|-----------|---------------------|---------------|----------|
| B        | C10115009 | 8-3-13              | Active        | B        |
| A        | C10103592 | 1-19-06             |               |          |

**KNOWLES ELECTRONICS**  
ITASCA, ILLINOIS U.S.A.

WHEN TEST LIMITS ARE USED TO ESTABLISH INCOMING INSPECTION ACCEPTANCE/REJECTION CRITERIA, CORRELATION OF TEST EQUIPMENT WITH KNOWLES IS ALSO REQUIRED FOR ELIMINATION OF EQUIPMENT AND TEST METHOD VARIATION

TITLE: **RECEIVER**  
PERFORMANCE SPECIFICATION

**FEC-26368-102**  
SHT 2.1

|         |         |
|---------|---------|
| DR. BY  | DATE    |
| AB      | 1-19-06 |
| CK. BY  | DATE    |
| GJP     | 1-26-06 |
| APP. BY | DATE    |
| GJP     | 1-26-06 |